

SET 1

Presentation:

- Set of 23 m x 16 m x 7 m (height). Set area: 368 m²
- Mixed zone of 115 m².
- Office of 42 m², Wi-Fi included.
- Fitting room of 26 m², mirror and three chairs are included.
- 1 restroom.
- 1 bathroom with shower.
- Water fountain.

Set specifications:

- "L"- shape of 14 m (frontal) x 6 m (height); 13 m (left) x 6 m (height).
- 9 metal structures (6 m x 3 m) for illumination, adjustable in height and inclination.
- Wood floor.
- Current supply of 200 kW. **(SERVICEVISION will be not responsible for any problem arised from the power supplied by the electrical company).**
- Set gate of 5.5 m x 4 m clearance (for trucks).
- Private alley for vehicles and pedestrians to access to the set.

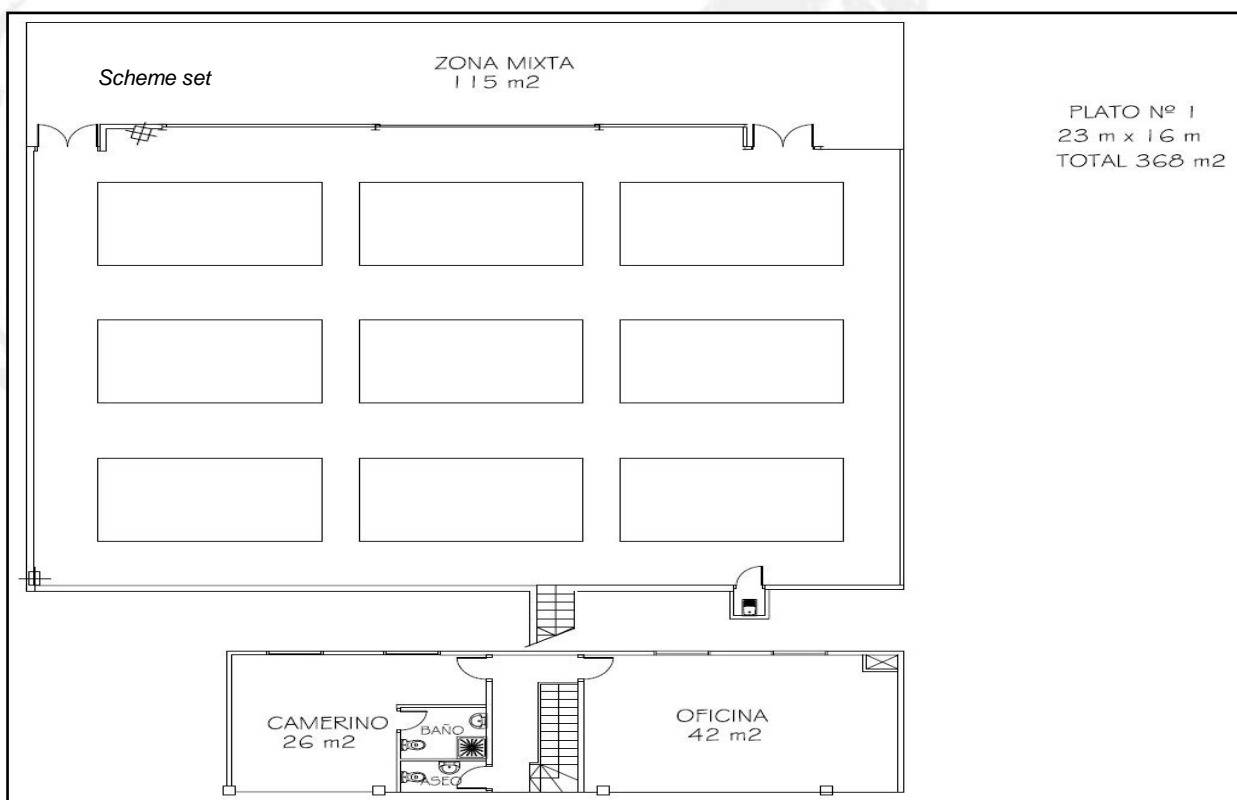

SET 1

General conditions:

- *The costs por any paint for the cyclorama is not included and mus be assumed by the user.*
- *If it's necessary to paint on the floor set outside the painted area should be done on overlapping base and removed it at the end of the filming.*
- *Private and exclusive access to the Set 1 and 2-3. Vehicle parking and material storage are not allowed in this area*
- *Total weight of the vehicles must not exceed 7,500 kg, any truck of more than 7 m in length will be unloaded from the aisle without access within the set.*
- *The maximum permissible weight on the set is 1000 kg per m².*
- *Working with minors: Any collaboration of minors under 16 years of age must have the prior express authorization of the Departament d'Empresa i Ocupació de la Generalitat de Catalunya. The producer concerned is responsible for its processing and compliance.*
- *Working with animals: The professional in charge of the animal will be responsible for keeping all vaccines up to date, requesting all permits, corresponding licenses and controlling the safety around them.*
- *Shooting with smoke: The person in charge of set will be warned in advance.*
- *Any complementary power generator must be parked and operate from the street.*

Usage specifications:

- *The personnel list will be sent to the set responsable, at least one day in advance.*
- *Painting the cyclorama is not included in the rental of the set.*
- *The color of the cyclorama will be the one left by the last user. In case of willing to take advantage of the painting it is advisable to check it before the day of filming.*
- *Any dark colors must be repainted in white at the end of filming.*
- *Set cleaning and decoration removal is on charge of the user. The set must remain clean and empty once the filming is finished.*

SET 1

Accessories:

- Multipurpose area of 300 m² distributed in 4 offices of 15 m² and 2 rooms, one of 63 m² and another of 93 m² with 6 toilets.
- Roof of 9,5 m x 9,5 m to reflect the light (in White). Adjustable in height and angle.

Price list:

- Filming day, from 8:00 am to 20:00 pm (including Set Technician).....	1300€
Day of assembly and dismantle	
- (From 8.00 am to 20.00 pm) Including Set Technician	650€
- Extra Hour of the set (Including Set Technician).....	110€
- Multipurpose area First Floor.....	250€
- Chair rental (Price per day).....	1.25€
- Table rental (Price per day).....	6€
- Iron board rental (Price per day).....	10€
- Mobile roof rental (Price per day).....	200€
- Shoe cover (100 units).....	10€
White paint.....	50€
- kW of light.....	0.5€/kW
- kW of air condition (without heating).....	0.5€/kW

Extra charges:

Saturday, Sundays and Holidays: add an extra 20%.
For each ID card not returned, 5€ will be charged.

Cancellation policy:

- 25% 72 h* before the rental.
- 50% 48 h* before the rental. (*) From Monday to Friday
- 100% 24 h* before the rental.

TAXES are not included as well as any service not specifically consigned. Equipment and personnel must be insured. It must be paid on cash.

SERVICEVISION will not be responsible for the loss or theft of any material or personal belongings during the days of usage.

SET 1

Alquiler de material de producción:

Steamer, plancha, tabla de planchar, perchas, burras, biombos, mesas, sillas, ventiladores, rulos, bases múltiples, adaptador corriente internacional, aspirador industrial, escalera, gato hidráulico para coches...

Venta material de producción:

Rollo papel film industrial (300 m), fotocopias, patucos, mascarillas...

Otros servicios:

*Carretilla y plataforma elevadora.**

Transpalet.

Limpieza y gestión de residuos.

**Solo se podrá alquilar la carretilla sin técnico presentando el carné de operador de carretillas elevadoras.*

Fechas de rodaje:.....

Atentamente

Conforme