

SET 4

- Set of 15 m x 15 m x 9 m (height)
- Set area: 225 m²
- Cyclorama with a "U" shape of 15 m x 15 m x 8 m x 6 m (frontal x right x left x height).
- 6 motorized structures (6 m x 3 m) of lights that are adjustable in height and inclination.
- Cement floor and Pladur cyclorama.
- Current supply of 200 kW. **(Servicevision will not be responsible for any kind of problem related with electric supply).**
- Set door of 4 m x 4 m (for trucks).
- Common area: 53 m²
- Parking lot: 150 m²
- Room 9 m², includes Wi-Fi.
- Dressing room, includes: two mirrors, two chairs.
- Restroom, includes: two toilets, three sinks and a shower (hot water).
- Set Officer from 8:00 am to 8:00 pm.
- Water fountain

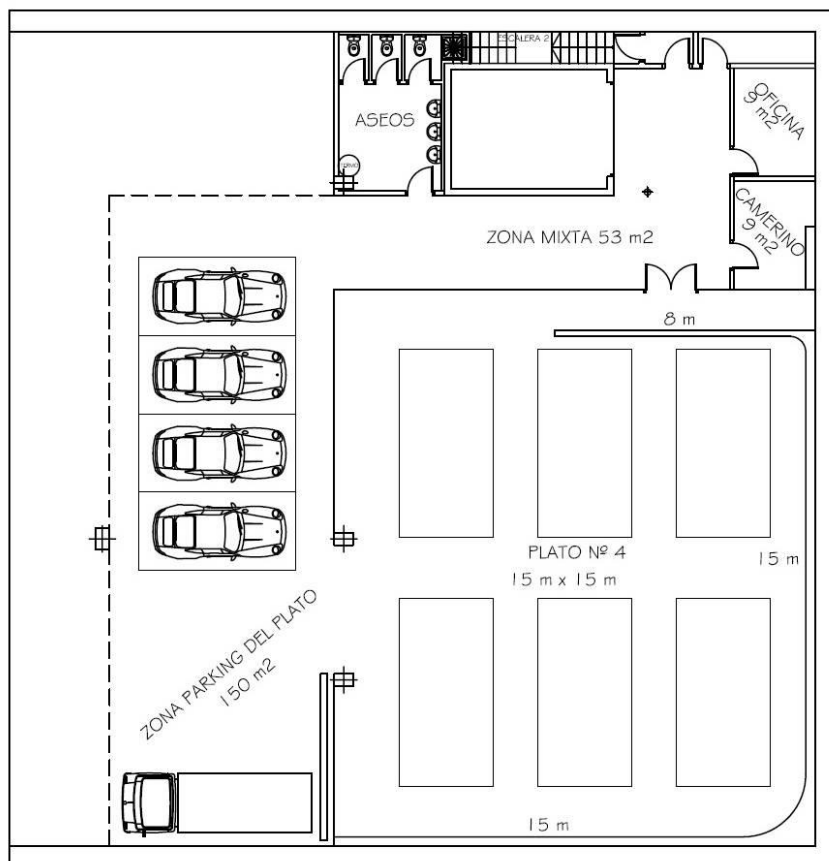

General conditions:

- *The costs for any paint for the cyclorama is not included and must be assumed by the user.*
- *If it's necessary to paint on the floor set outside the painted area should be done on overlapping base and removed it at the end of the filming.*
- *Working with minors: Any collaboration of minors under 16 years of age must have the prior express authorization of the Departament d'Empresa i Ocupació de la Generalitat de Catalunya. The producer concerned is responsible for its processing and compliance.*
- *Working with animals: The professional in charge of the animal will be responsible for keeping all vaccines up to date, requesting all permits, corresponding licenses and controlling the safety around them.*
- *Shooting with smoke: The person in charge of set will be warned in advance.*
- *Any complementary power generator must be parked and operate from the street.*

Usage specifications:

- *The personnel list will be sent to the Set Officer, at least one day in advance.*
- *Painting the cyclorama is not included in the rental of the set.*
- *The color of the cyclorama will be the one left by the last user. In case of willing to take advantage of the painting it is advisable to check it before the day of filming.*
- *Any dark colors must be repainted in white at the end of filming.*
- *Set cleaning and decoration removal is on charge of the user. The set must remain clean and empty once the filming is finished.*

Accessories

- *Movable roof of 9.5 m x 9.5 m to reflect the light (in White)*
- *Production equipment: Tables, chairs, iron, steamer, coat racks...*

Price list

- Shooting day from 8.00am to 8.00pm	800€
- Day of assembly or dismantle from 8:00am to 8:00pm	400€
- Extra hoour of the set (including Sets Officer)	110€
- Chair rental (price for day).....	1.25€
- Table rental (price for day).....	6€
- Iron board rental (price for day).....	10€
- Movable roof rental (price for day).....	400€
- Shoes cover (100 units).....	10€
- White paint can.....	75€

Cancellation policy

-25% 72 h* before rental.

-50% 48 h* before rental. (*) From Monday to Friday

-100% 24 h* before rental.

- Not included IVA or any service not specifically consigned. It must be paid in cash.
- The customer will take of any kind of damage and lamps. The customer will contribute with the own insurance of persons and material goods.

SERVICEVISION is not responsible of the lost or stealing of any material or personal belongings during the days of set usage.